

# APPENDIX 1

---

# **SCREEN PLANTING CONCEPT**

---

## **RUAKĀKĀ ENERGY PARK**

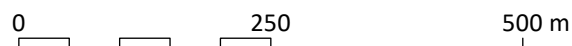

scale 1 : 7500 @ A3  
 Ref: 1338\_PlantingConcept\_20230904



**PLANTING CONCEPT OVERVIEW  
 RUAKĀKĀ ENERGY PARK**

# SCREEN MIX A & B



Plant centres 1m off-set from boundaries

Plant spacing 1.5m crs in off-set rows

1.5m 1.5m Site boundary

**SPECIES SCREEN MIX A**  
 Trimmed to maintain height of 5m  
*Kunzea robusta* kānuka 30%  
*Myrsine australis* māpou 15%  
*Pseudopanax lessonii* houpara 15%  
*Pittosporum crassifolium* karo 15%  
*Pittosporum tenuifolium* kohukohu 15%  
*Coprosma lucida* taupata 10%

**SPECIES SCREEN MIX B**  
 Trimmed to maintain height of 2.5m  
*Pittosporum crassifolium* karo

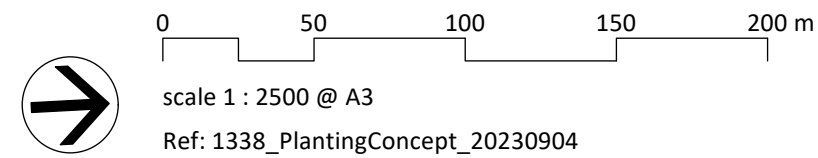

## PLANTING CONCEPT SOUTH EAST SITE 2 RUAKĀKĀ ENERGY PARK

INDICATIVE WETLAND CONCEPT



Lightly elevated, metallised power pylon access track.

Screen Mix A  
See South East Site 2 planting concept for species composition.

Dense mānuka *Leptospermum scoparium* (max. height 5m) shrubland with cabbage trees *Cordyline australis* (max. height 10m).

MERIDIAN SITE 3

Indigenous wetland species with maximum height of 1.5m, such as purei *Carex secta* and other *Carex* sp., kuta *Eleocharis sphacelata*, oioi *Apodasmia similis*, wīwī *Baumea rubiginosa* etc.

Clumps of flax *Phormium tenax* (max. height 2.5m)

Power pylon

Screen Mix C  
See Marsden Point Road frontage planting concept for species composition.

Marsden Point Road

McCathie Road

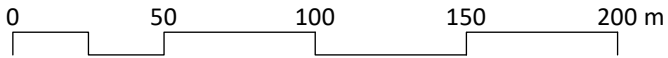

scale 1 : 2500 @ A3  
Ref: 1338\_PlantingConcept\_20230904



PLANTING CONCEPT SOUTH EAST SITE 3  
RUAKĀKĀ ENERGY PARK

INDICATIVE WETLAND CONCEPT WITH POWER PYLON OFF-SETS

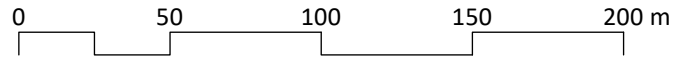

scale 1 : 2500 @ A3  
Ref: 1338\_PlantingConcept\_20230904



PLANTING CONCEPT SOUTH EAST SITE 3  
RUAKĀKĀ ENERGY PARK



## SCREEN MIX C

Plant centres 1m off-set from boundaries

Plant spacing 1.5m crs in off-set rows

### SPECIES SCREEN MIX C

- Leptospermum scoparium* mānuka 40%
- Phormium tenax* harakeke/flax (on outer, road side of mix) 20%
- Pseudopanax lessonii* houpara 15%
- Pittosporum crassifolium* karo 10%
- Callistemon citrinus* "Endeavour" 10%
  - in periodic clumps of 3
- Leucadendron* 'Safari Sunset' 5%
  - in periodic clumps of 3, but separated from *Callistemon*

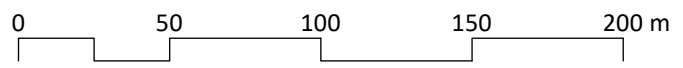
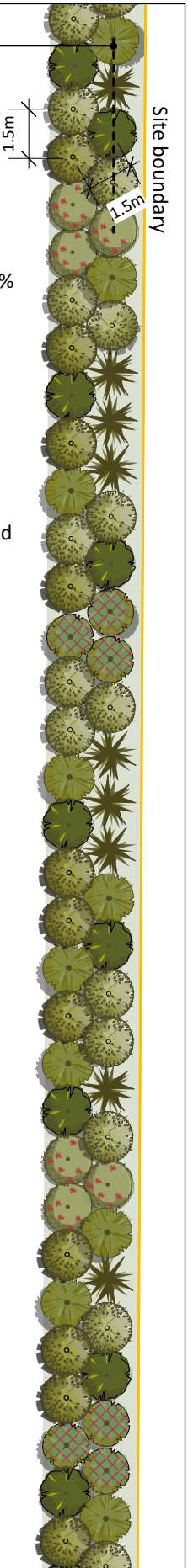

scale 1 : 2500 @ A3

Ref: 1338\_PlantingConcept\_20230904



## PLANTING CONCEPT MARSDEN POINT ROAD FRONTAGE RUAKĀKĀ ENERGY PARK